

Sofitel Brisbane

249 Turbot Street, Brisbane 4000
The Official WLA 2010 Convention Hotel
★★★★★ 5 star

Distance from Brisbane Airport – 14.8kms
Distance from Brisbane Convention Centre – 1.5kms

Room Rates

Standard Superior Room	A\$245 per room per night
Luxury Room	A\$285 per room per night
Luxury Club Room	A\$375 per room per night
Junior Suite	A\$525 per room per night

** Please note these rates are only available by booking through the conference organiser ICMS Australasia*

All rooms include:

- Fully stocked mini bar
- Hairdryer
- Ironing facilities
- Colour LCD TV with movies on demand
- Modem / facsimile access
- French amenities
- Tea and coffee making facilities
- Bathrobes
- Broadband Internet
- Individually controlled air conditioning

Hotel features:

- Largest number of VIP accommodation rooms in Brisbane
- Australia's largest executive club lounge
- 3 in-house restaurants
- Cuvee Lounge Bar
- State of the art meeting rooms / boardrooms
- Stephanie's Spa Retreat
- Beauty salon and hairdresser
- Supervised fitness centre
- Heated outdoor swimming pool
- Fully equipped Business Centre
- Broadband Internet access
- 24 hour concierge service
- Baby sitting service
- 24 hour in-room dining
- All major credit cards accepted
- Laundry and dry cleaning service
- Currency exchange facilities
- Security deposit boxes available
- Medical services available on call
- Wheelchair accessible rooms
- Covered parking facilities
- Live entertainment in Cuvee Lounge Bar
- Smoking room available on request

Accommodation Fact sheet

Guests of the Sofitel Brisbane will enjoy a luxury accommodation experience in elegant rooms with stunning city views. The hotel is only a five minute walk from the heart of Brisbane City, with easy access to quality shopping, cafes, restaurants and cultural facilities. A designated shuttle bus will provide door to door transfers for WLA2010 delegates. Alternatively, the hotel offers easy access to the Brisbane Convention and Exhibition Centre via train. The Cuvee Lounge Bar offers an ideal space to network, entertain or relax.



Standard Superior Room A\$245 per room per night

These elegantly appointed rooms offer a king-size bed or twin double beds, an abundance of natural light and lovely city views. Superior Rooms are located on levels 10-17. Maximum two adults per room utilising existing bedding.

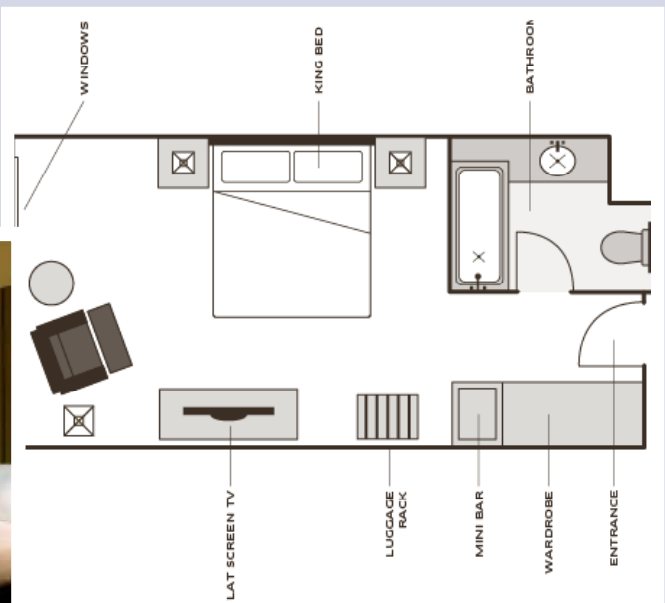
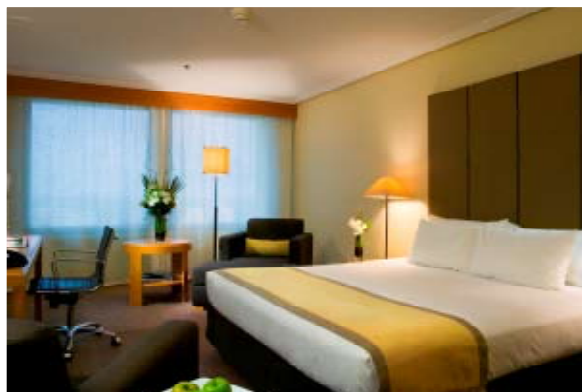



Luxury Room A\$285 per room per night

Luxury Rooms offer premium accommodation, including a unique Sofitel king-size bed and an abundance of natural light. Luxury Rooms feature the same layout as Standard Superior Rooms, with the additional inclusions of two pressed items of laundry per day and complimentary Internet access. These rooms are located on levels 18-24.

Luxury Club Room A\$375 per room per night

The stylish Luxury Club Rooms offer an abundance of natural light and plenty of space to retreat and relax. Luxury Club Rooms are available in a king bed or twin (2 x double beds) arrangement and are located on levels 25-29 of the hotel. Maximum four adults per room (using twin configuration). Guests in Luxury Club Rooms have access to the Club Sofitel Lounge.

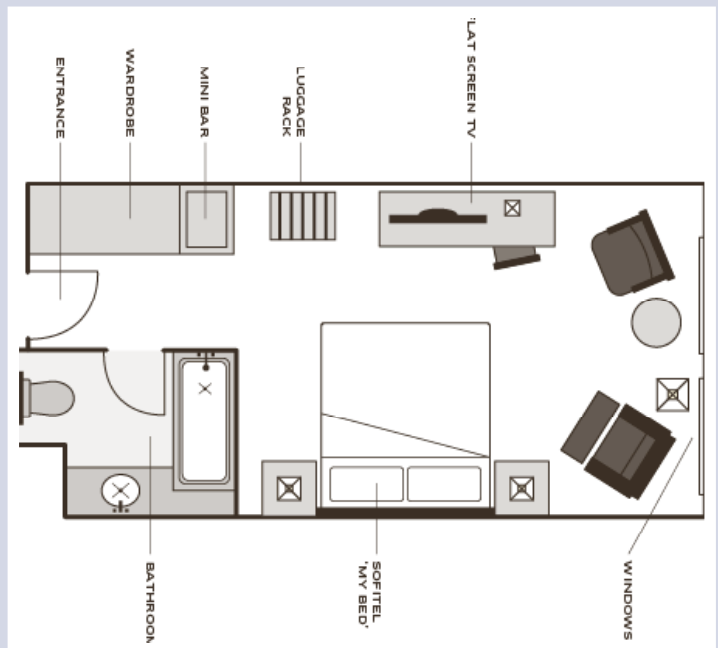



Sofitel Junior Suites A\$525 per room per night

The Sofitel's Junior Suites are designed as a 'home away from home' for the busy executive. These spacious suites feature separate living and sleeping areas, with king-size bed and a naturally lit bathroom with separate bath and shower.

Guests staying in Junior Suites have access to the Club Sofitel Lounge.

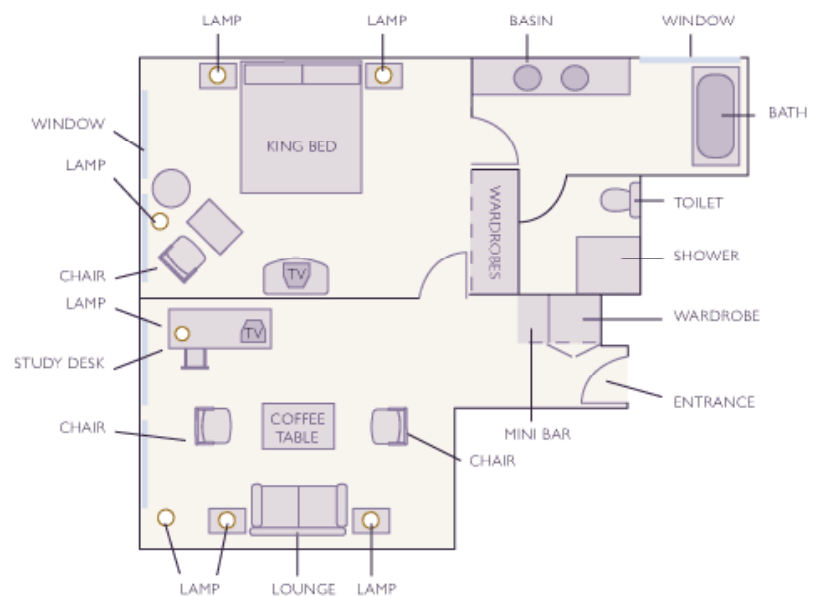



Club Sofitel Lounge

The Club Sofitel Lounge is Australia's largest and most contemporary executive lounge. Situated on the 30th floor of the hotel, the lounge offers unrivalled views of Brisbane's skyline and an ideal environment to work, relax or entertain.

Club Sofitel exclusivity includes:

- All day access
- Priority check-in and check-out
- Complimentary Internet access and business facilities
- Evening beverages and freshly prepared canapés from 5.30pm to 8.00pm
- Hot and cold Club breakfast selection
- All day refreshments, including tea, coffee, soft drinks, cookies and cakes
- Reduced rate valet car parking
- Complimentary use of gymnasium and heated pool